



LOAD-MASTER *SLP*

Load Indicating Shackle

3.25tonne to 100tonne

Standard Shackle Sizes

Stainless Steel Pin & Bobbin

Cabled (*SLP-C*) or Wireless (*SLP-W*)

LOAD MONITORING • FORCE MEASUREMENT • WEIGHING

Rated Capacities	3.25 , 5 , 12 , 25 , 50 , 100 tonne	
Display Units	tonne (other units on request)	
Battery Life	100 Hours min.	
Wireless Range	200 Metres	(direct sight)
Maximum Error	1 %	% Reading
Overload Capacity	200%	% Capacity
Safety Factor	5 : 1	
Operating temp.	-10 to +60	°C
Environmental Sealing	IP65	to BS EN60529

Capacity	A	B	C	D
3.25	27	57	74.5	17.5
5	36	80	102	25
12	51	115	146	35
25	60	140	175	41
50	82	260	258	61
100	127	310	371	83
tonne				mm

Includes :

SLP-C: Load Sackle, H100 Remote Display, 10Metres Cable

SLP-W: Load Shackle, HS-FL-PH Wireless Display

Screen Resolution

Capacity:	Divison:
3.25 tonne	5kg
5 tonne	5kg
12 tonne	10kg
25 tonne	20kg
50 tonne	50kg
100 tonne	100kg

Shipping Weight

Capacity:	Weight:
3.25 tonne	2kg
5 tonne	4kg
12 tonne	8kg
25 tonne	19kg
50 tonne	48kg
100 tonne	80kg

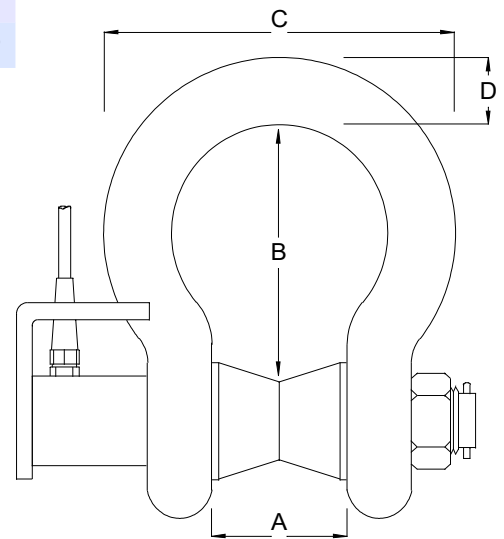

The information provided is intended for product description only.
Specifications are subject to change.
Full product details available on request.

FORCE LOGIC UK LTD
N4 Lambs Farm Business Park
Swallowfield, Berkshire, RG7 1PQ, UK
T: +44 (0)118 988 8807
E: sales@force-logic.co.uk
W: www.force-logic.co.uk

SLPDS_2.0

Force
LOGIC UK

MANUFACTURED IN THE UK 